

ORDINANCE NO. 97- 5031

AN ORDINANCE AMENDING ORDINANCE 97-5020: AN ORDINANCE OF THE CITY OF BILLINGS, AMENDING BILLINGS MUNICIPAL CODE, CHAPTER 11, ELECTIONS, IN PARTICULAR, SECTION 11-102(c), WARD BOUNDARIES; AND CHANGING THE WARD BOUNDARIES ESTABLISHED THEREIN BY ADDING CERTAIN NEWLY ANNEXED REAL PROPERTY TO WARD I, PROVIDING FOR CERTIFICATION AND REPEALING OF ALL ORDINANCES AND RESOLUTIONS INCONSISTENT THEREWITH.

BE IT RESOLVED BY THE CITY COUNCIL OF THE CITY OF BILLINGS, MONTANA:

1. AMENDMENT. Pursuant to Billings Municipal Code, Section 1.16.030, and the State Law, Billings Municipal Code, Section 1.16.030 Ward Boundaries, is hereby amended by adding to the following designated Ward the following described real property:

WARD I:
Description corrected to read:

The unplatted portion of Section 16, ~~Section 6~~, Township 1 South, Range 26 East, more specifically described in Exhibit "A" attached; and
C/S 2655;

Containing 22.1278 acres, more or less. (#97-01)

2. CERTIFICATION. Pursuant to M.C.A. Section 13-3-103, the above change and alteration is hereby certified to the election administrator by the City Council, and the City Administrator or his designee is hereby directed to certify the changes and alterations and to deliver a map showing the boundaries of the ward, the streets, avenues and alleys by name, and the ward by number, to the election administrator not more than ten (10) days after the effective date of this ordinance.

3. REPEALER. All other ordinances, sections of the Billings Municipal Code and ordinances inconsistent herewith are hereby repealed.

PASSED by the City Council on the first reading this 23rd day of June, 1997.

PASSED, ADOPTED AND APPROVED on second reading this 14th day of July, 1997.



THE CITY OF BILLINGS:

BY: Charles F. Tooley
Charles F. Tooley, MAYOR

ATTEST:

BY: Marita Herold
Marita Herold, CMC CITY CLERK

ANNEXATION MAP

ANNEXATION NO. 97-01

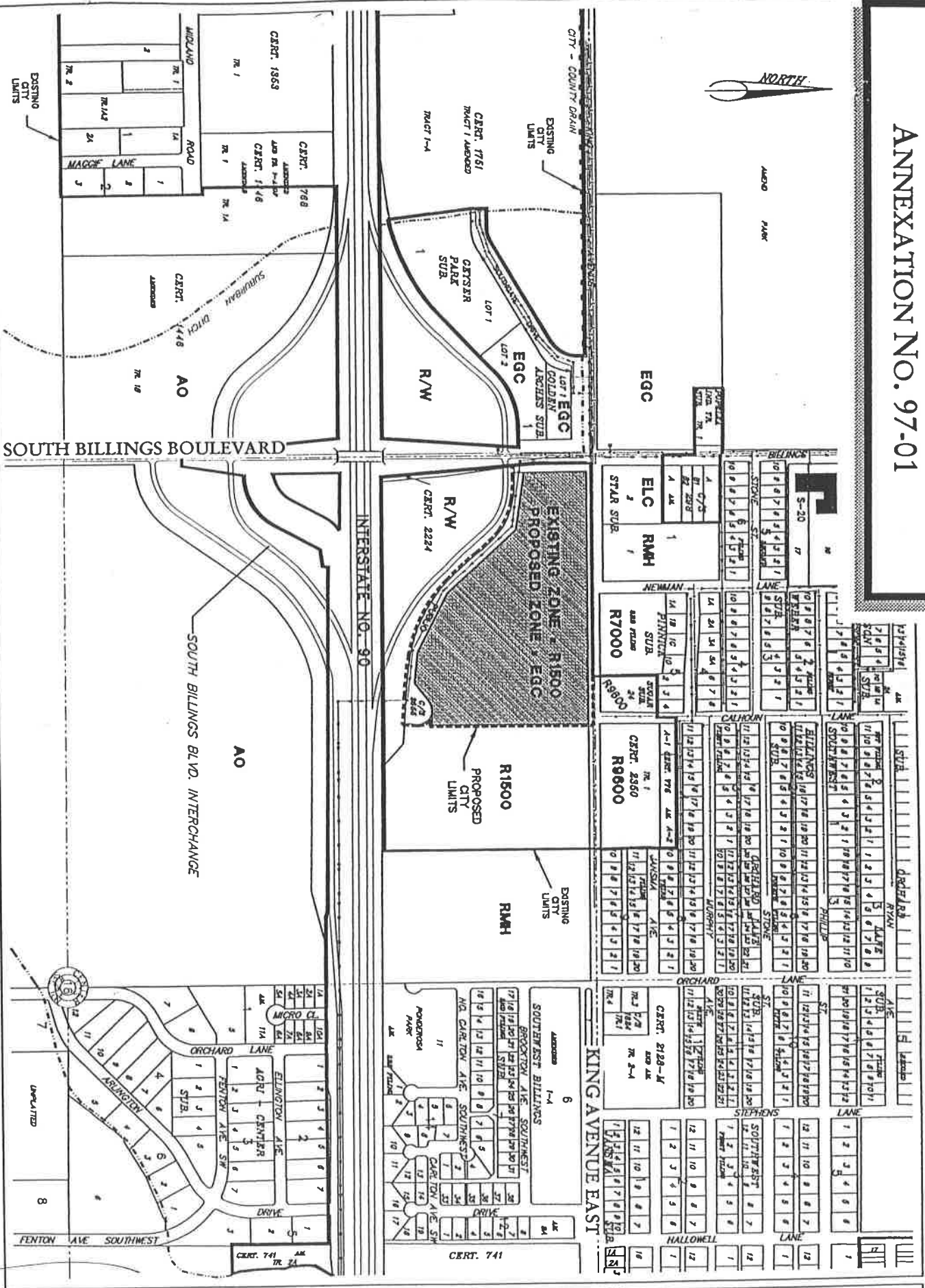

SCALE: 1" = 200'
 FILE: ANNEX-01
 PROJECT: 97-0001
 SHEET: 1 OF 1

MILLER CROSSING
 SOUTH BILLINGS BLVD AND KING AVENUE EAST
 BILLINGS, MONTANA

ANNEXATION MAP

ENGINEERING, INC.
 CONSULTING ENGINEERS & LAND SURVEYORS

1001 300 CENTER
 1001 300 34TH ST. WEST
 BILLINGS, MONTANA 59102-1346

DESCRIPTION OF PROPERTY REQUESTING ANNEXATION

The southerly portion of King Avenue East from the easterly right-of-way line of South Billings Boulevard to the easterly right-of-way line of Calhoun Lane, and an unplatted area to the south of the above described portion of King Avenue East (to be platted as the Miller Crossing Subdivision) and including Certificate of Survey No. 2655, all generally situated between South Billings Boulevard, King Avenue East, Interstate 90 and the extension of the east right-of-way line of Calhoun Lane in the NW⁴ of Section 16, T.1S., R.26E., P.M.M. more particularly described as follows:

Beginning at a point on the north section line of Section 16, T.1S., R.26E., P.M.M. which is N89°54'26"E a distance of 80.00 feet from the northwest corner of said Section 16, T.1S., R.26E.; thence, N89°54'26"E along said north section line a distance of 1270.79 feet; thence, S00°05'34"E a distance of 851.45 feet; thence, S89°54'26"W a distance of 105.46 feet to a point on the north line of C/S 2655; thence, along a nontangent curve to the right with a $\Delta = 94^{\circ}19'00''$, a radius of 70.00 feet, a distance of 135.23 feet; thence, S00°13'26"W a distance of 65.01 feet, to a point on the north right-of-way line of Ramp B-2 of the South Billings Boulevard Interchange; thence, N85°46'34"W along said right-of-way line a distance of 130.27 feet; thence, along said north right-of-way line along a spiral with $e_s = 8^{\circ}18'05''$, $L_s = 214.00$ feet and $T_s = 434.02$ feet, along a circular curve with $\Delta_c = 31^{\circ}09'58''$, $D_c = 7^{\circ}45'30''$, $R_c = 738.51$ feet; $T_c = 205.96$ feet and $L_c = 401.71$ feet, and along a spiral curve with $e_s = 8^{\circ}18'05''$, $L_s = 214.00$ feet and $T_s = 434.02$ feet, and along a spiral curve with $e_s = 11^{\circ}08'07''$, $L_s = 142.45$ feet and $T_s = 238.82$ feet, and along a circular curve with $\Delta_c = 27^{\circ}48'09''$, $D_c = 15^{\circ}38'03''$, $R_c = 366.48$ feet, $T_c = 90.70$ feet and $L_c = 177.83$ feet, and along a spiral curve with $e_s = 9^{\circ}47'58''$, $L_s = 125.36$ feet and $T_s = 232.42$ feet; thence, S89°50'15"W a distance of 13.32 feet to the easterly line of South Billings Boulevard; thence, N00°09'44"W along said easterly right-of-way line a distance of 424.75 feet to the point of beginning, encompassing 22.1278 acres more or less.